

TRAVAUX DE VÉRINAGE – CONFIGURATIONS POUR TRAVAUX DE VERINAGE SUR PILES ET CULEES

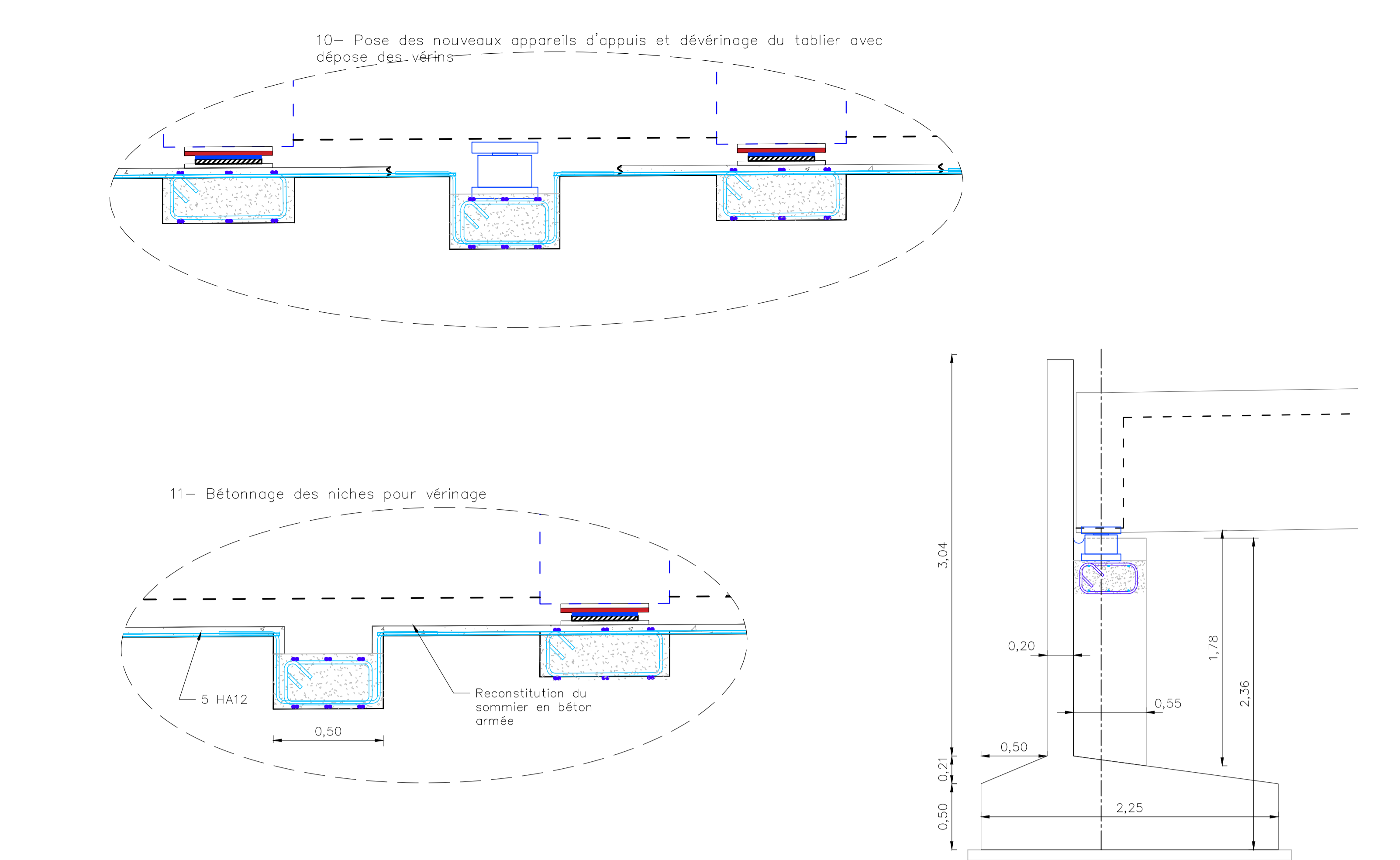

VERINAGE SUR PILES

Détail appareils d'appui projetés sur les piles intermédiaires P2 et P4 et sur la pile centrale P3

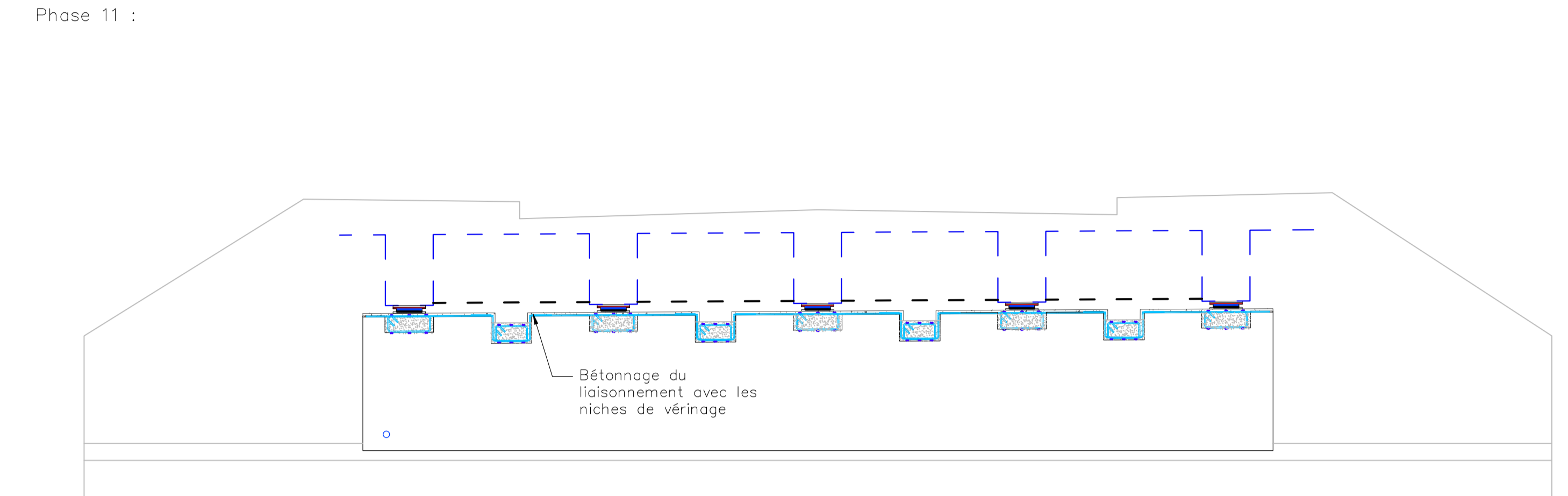
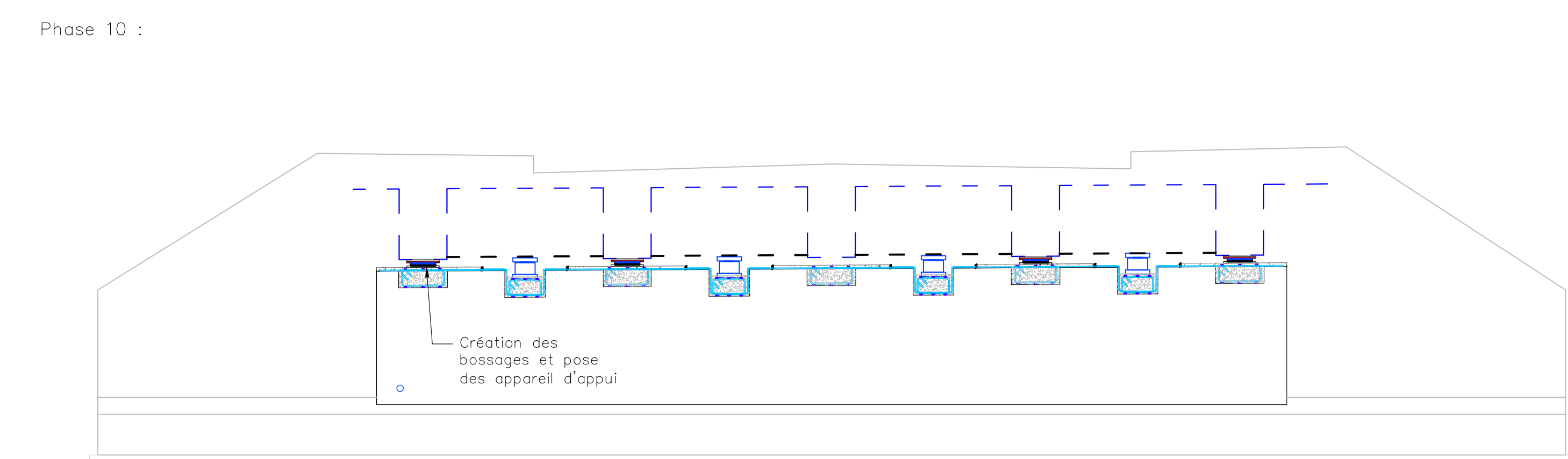
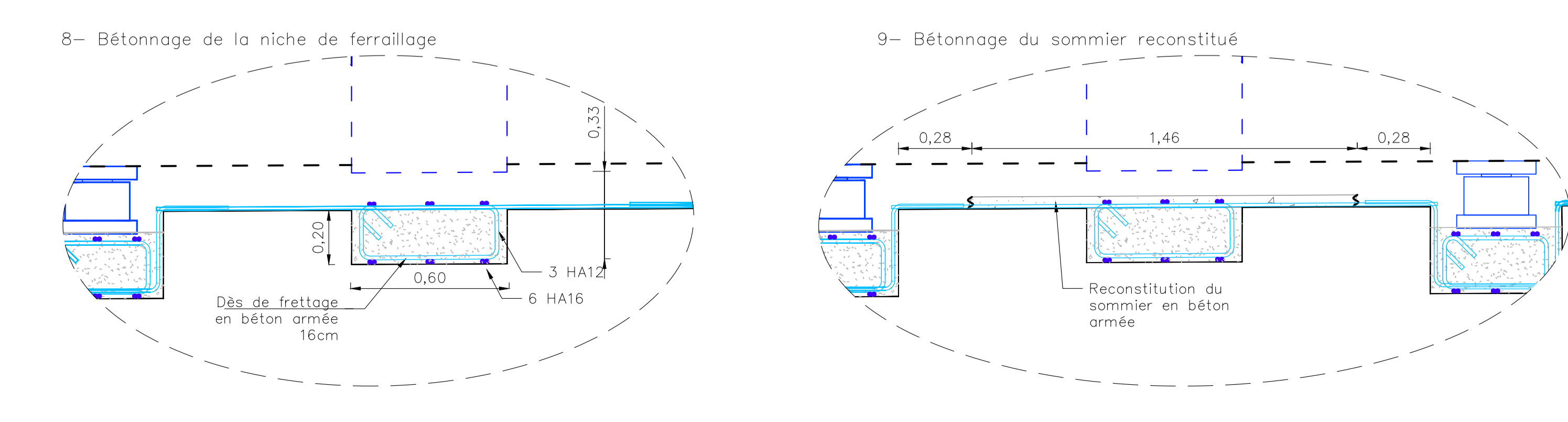
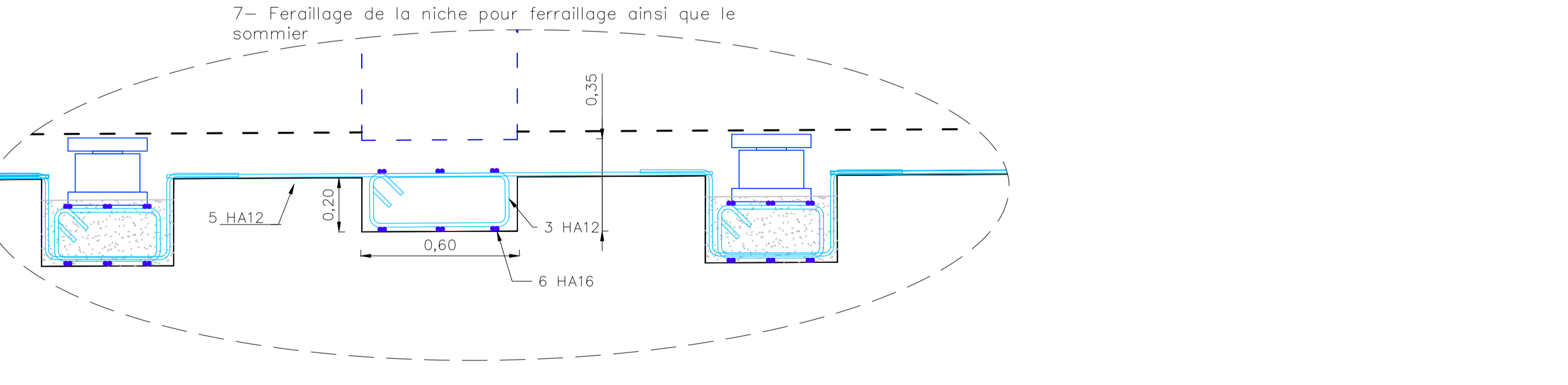
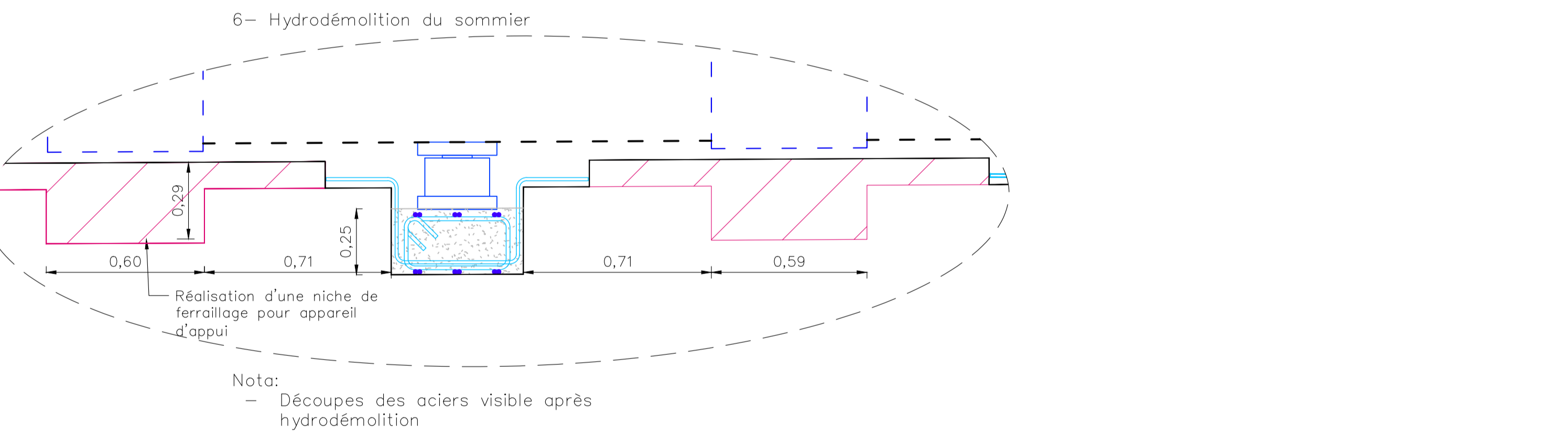
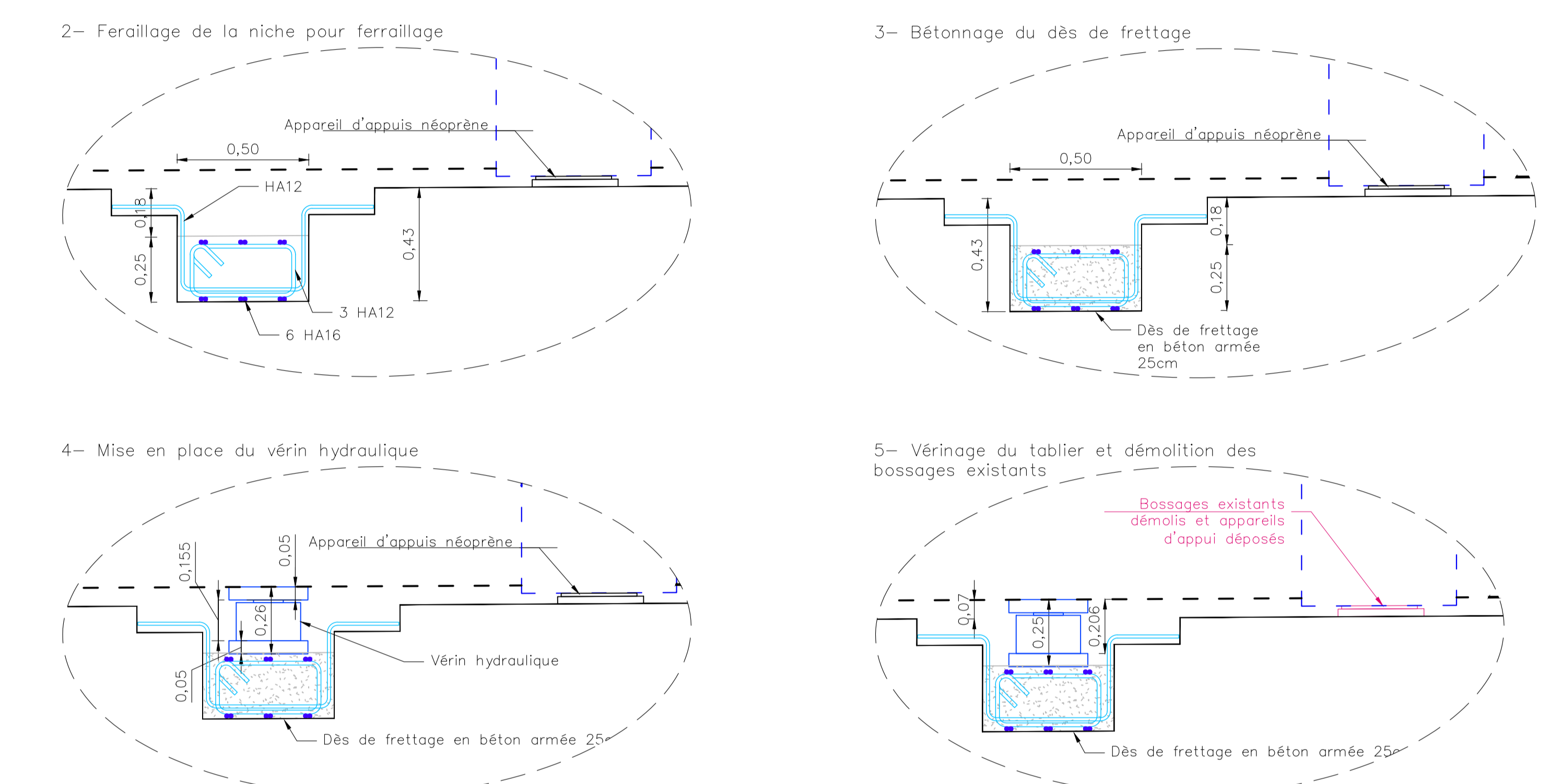
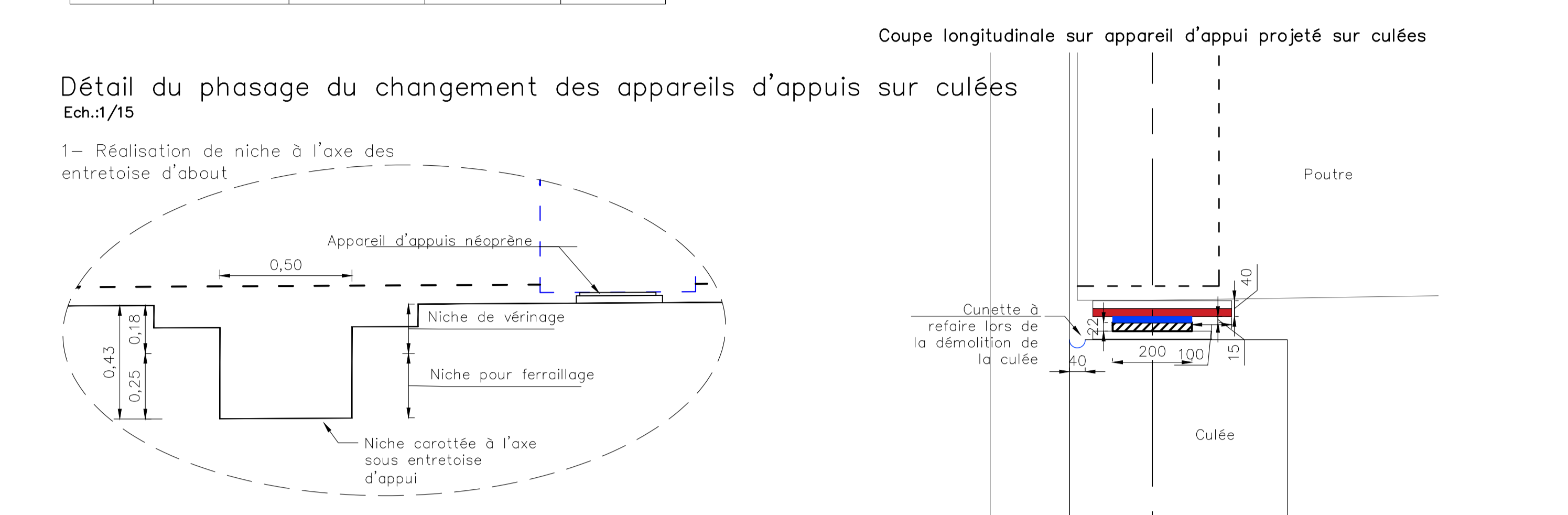
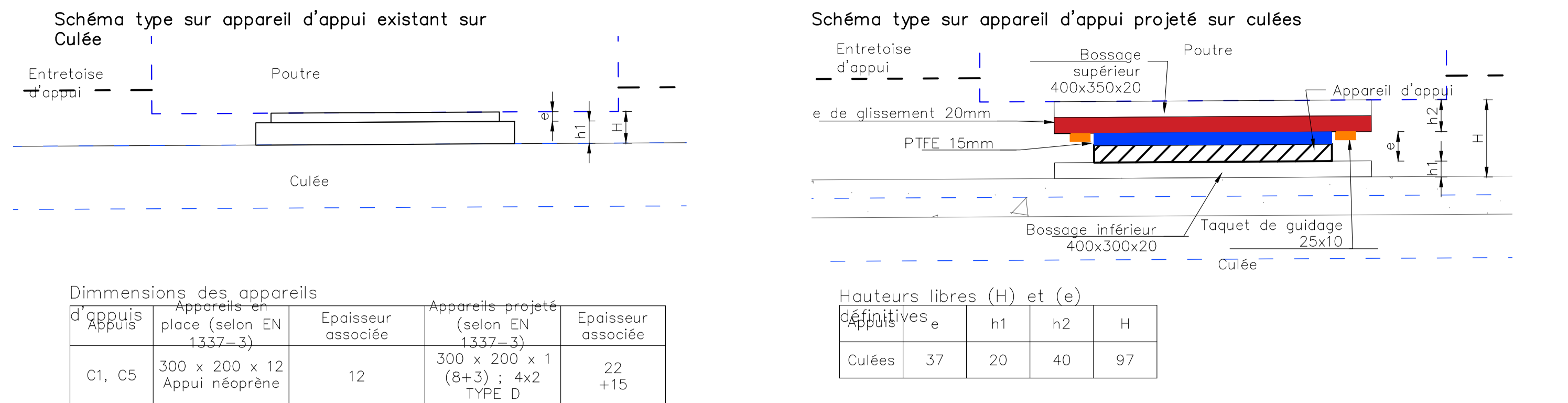
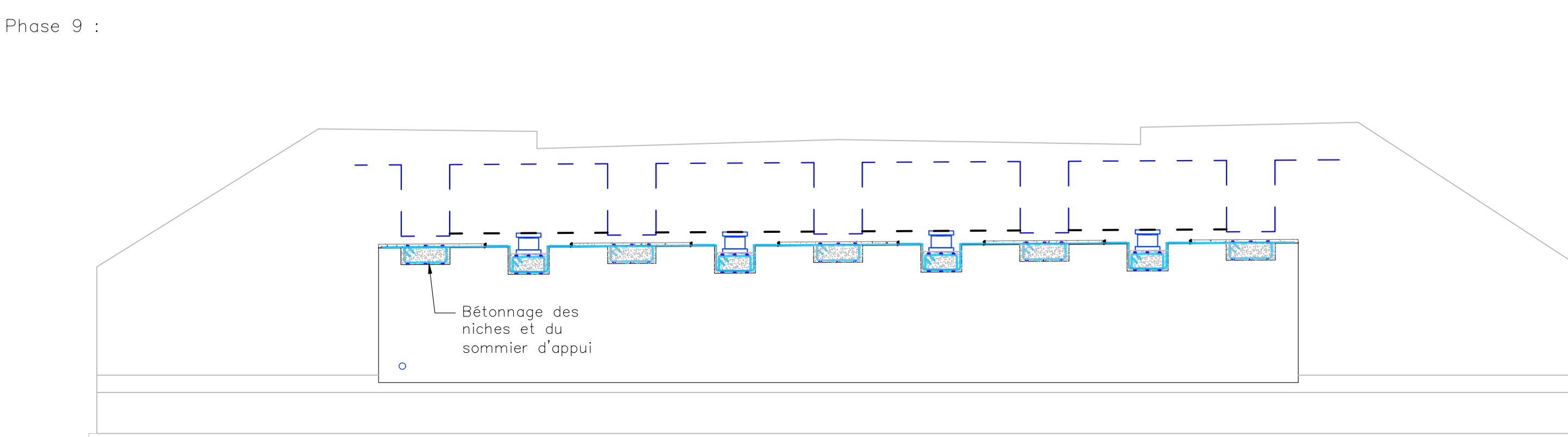
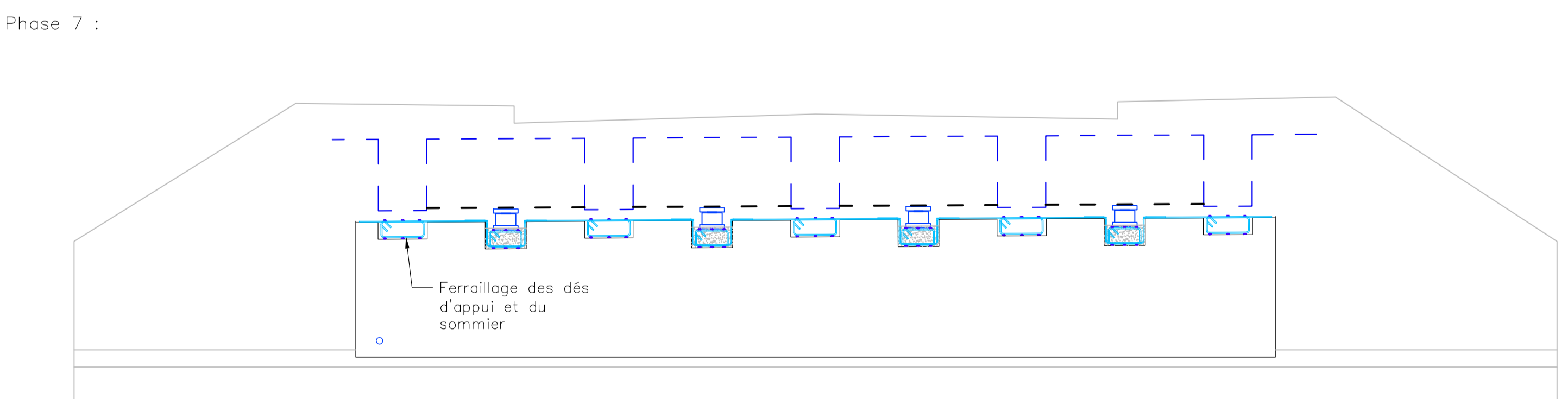
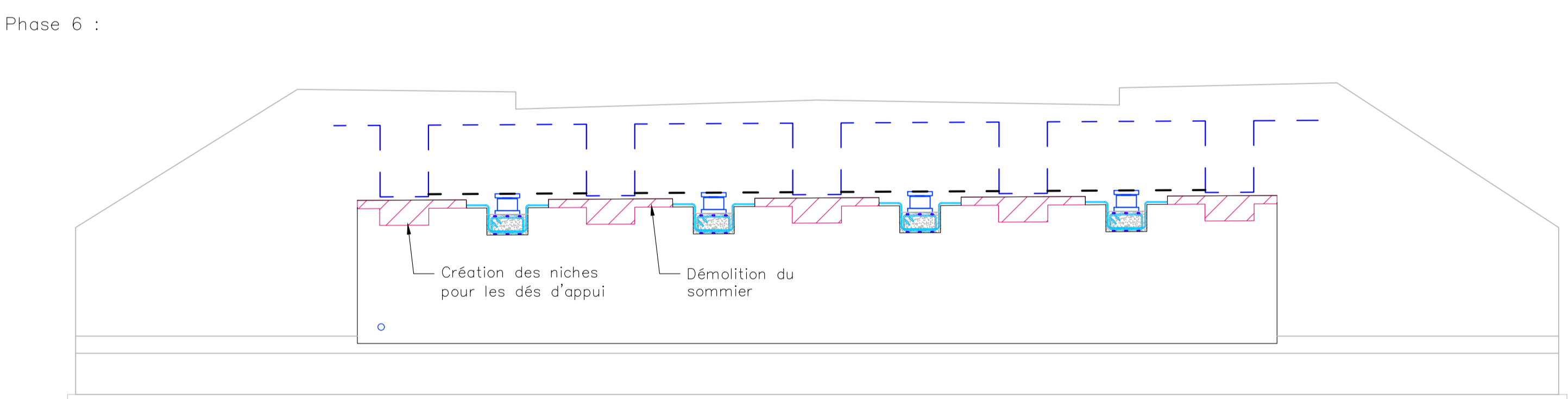
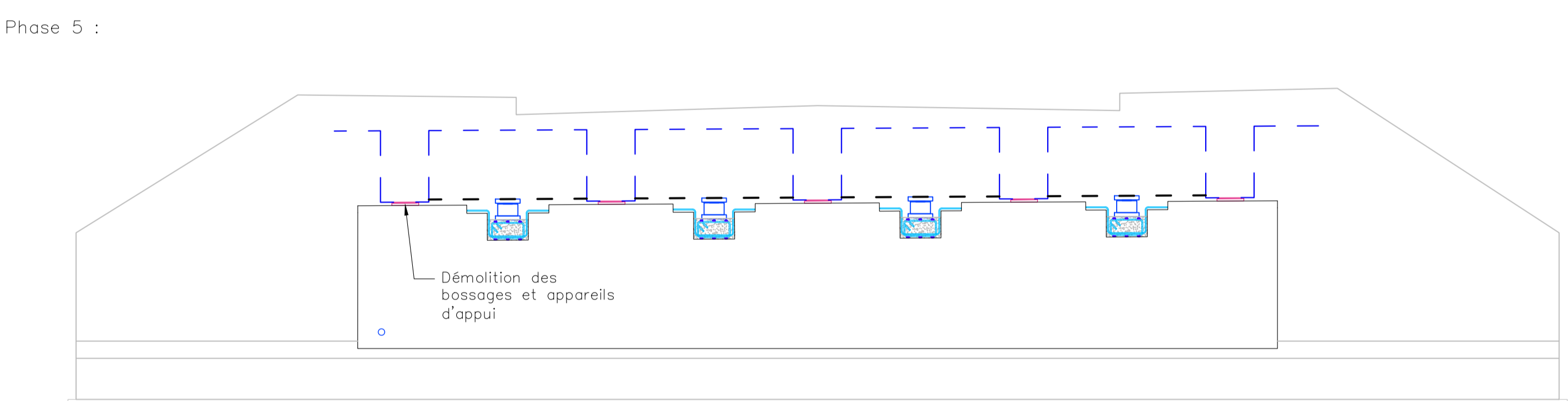
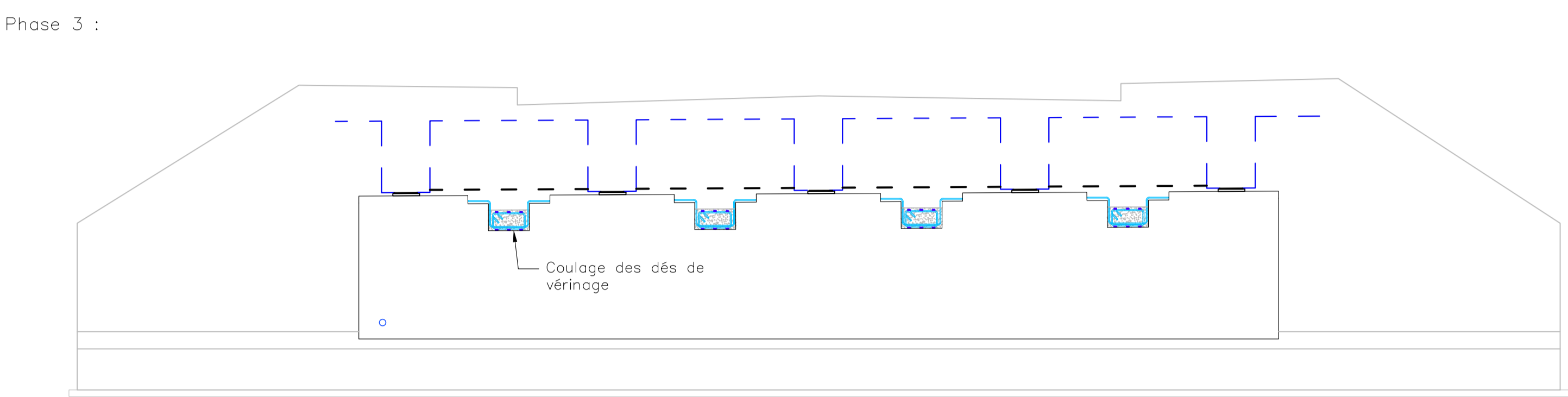
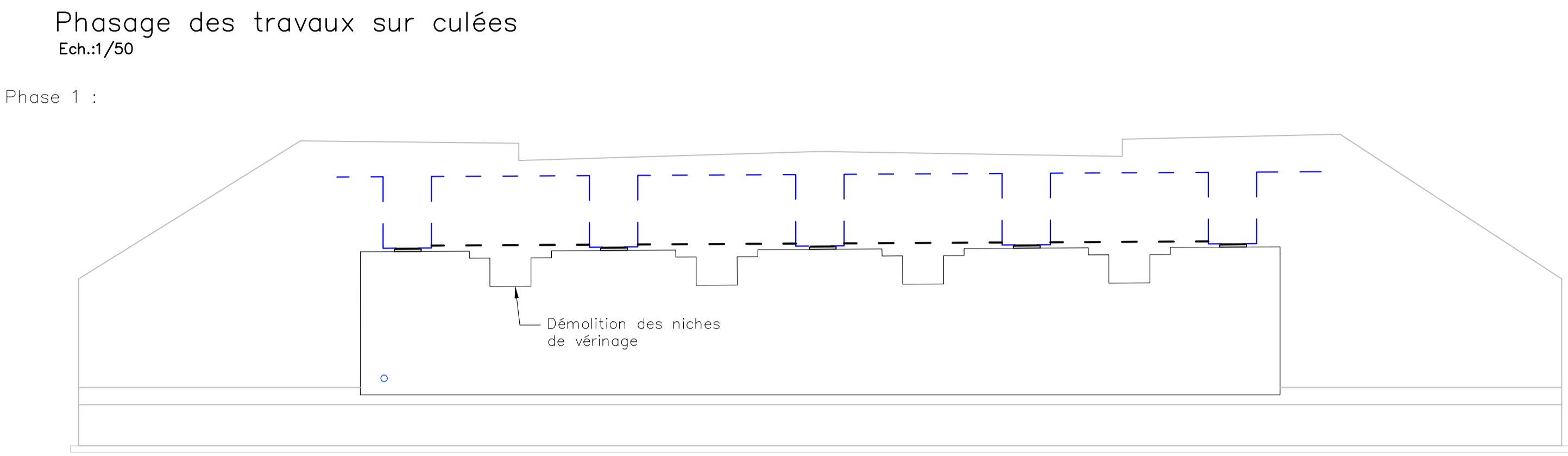
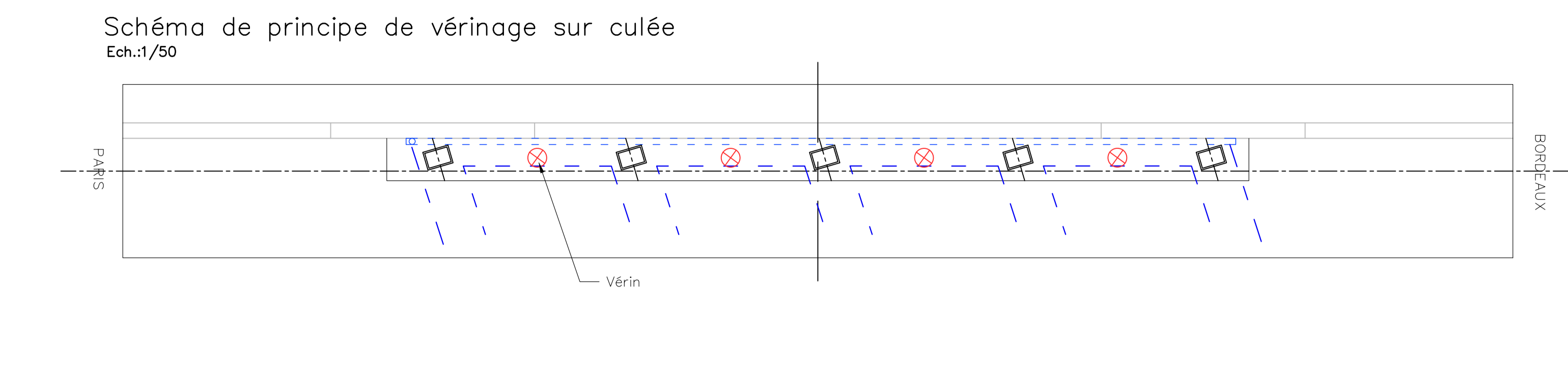
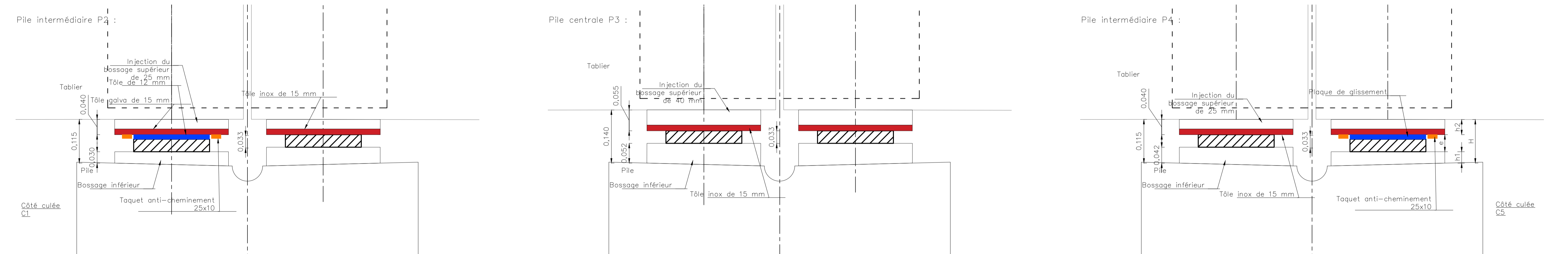

Elévation – Détail consoles

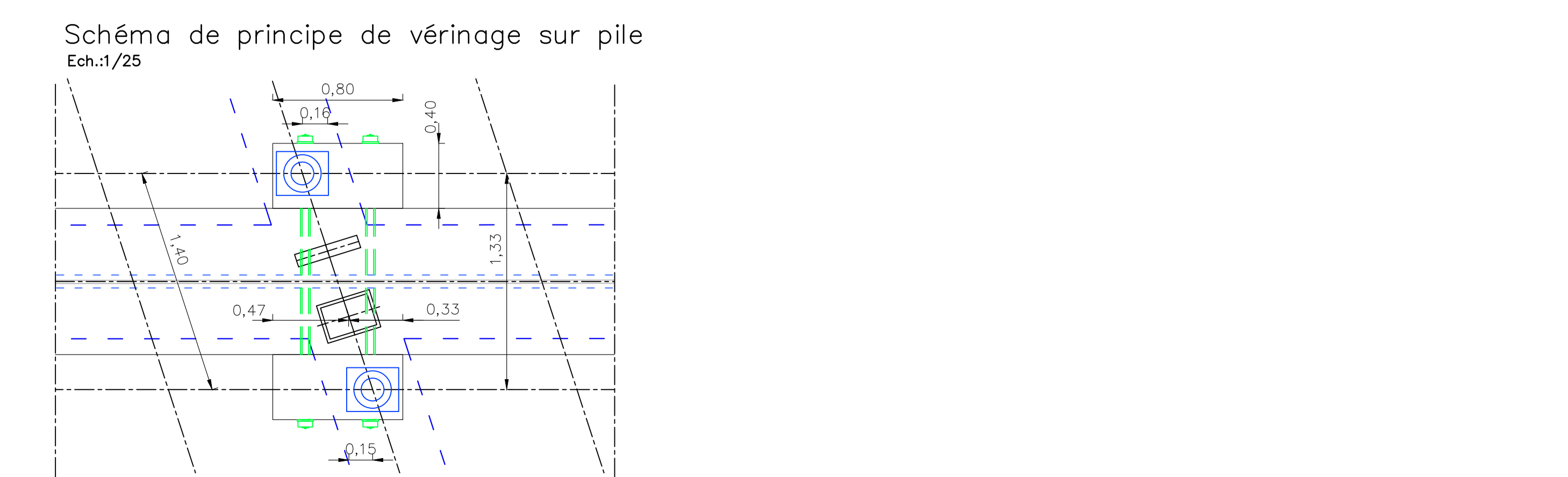
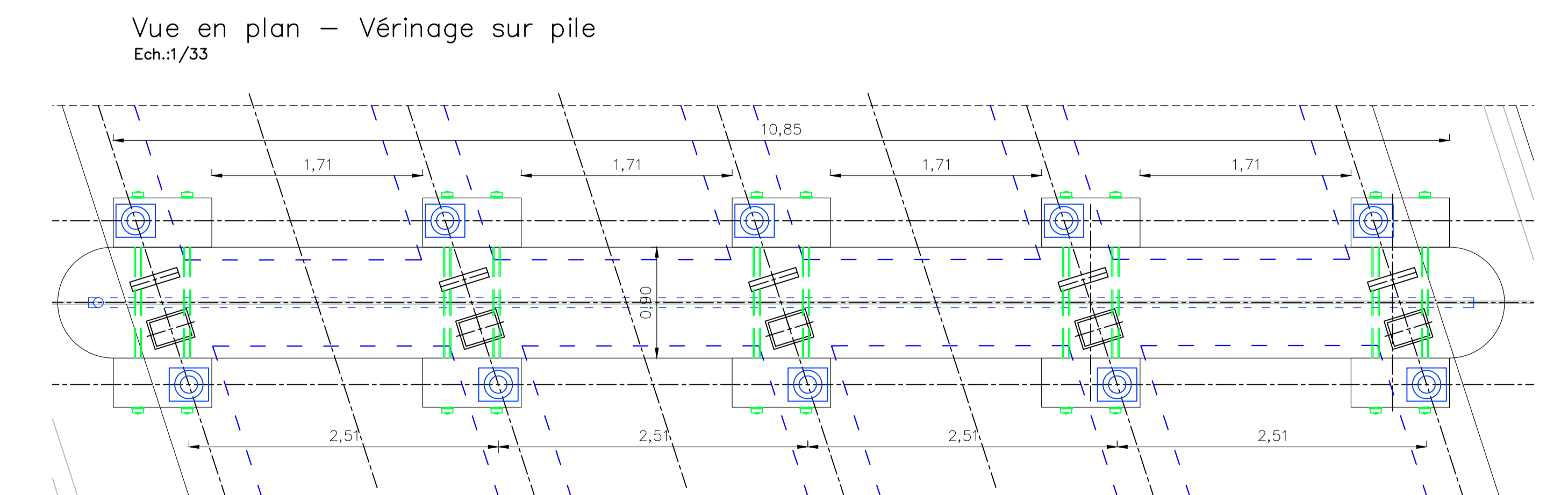
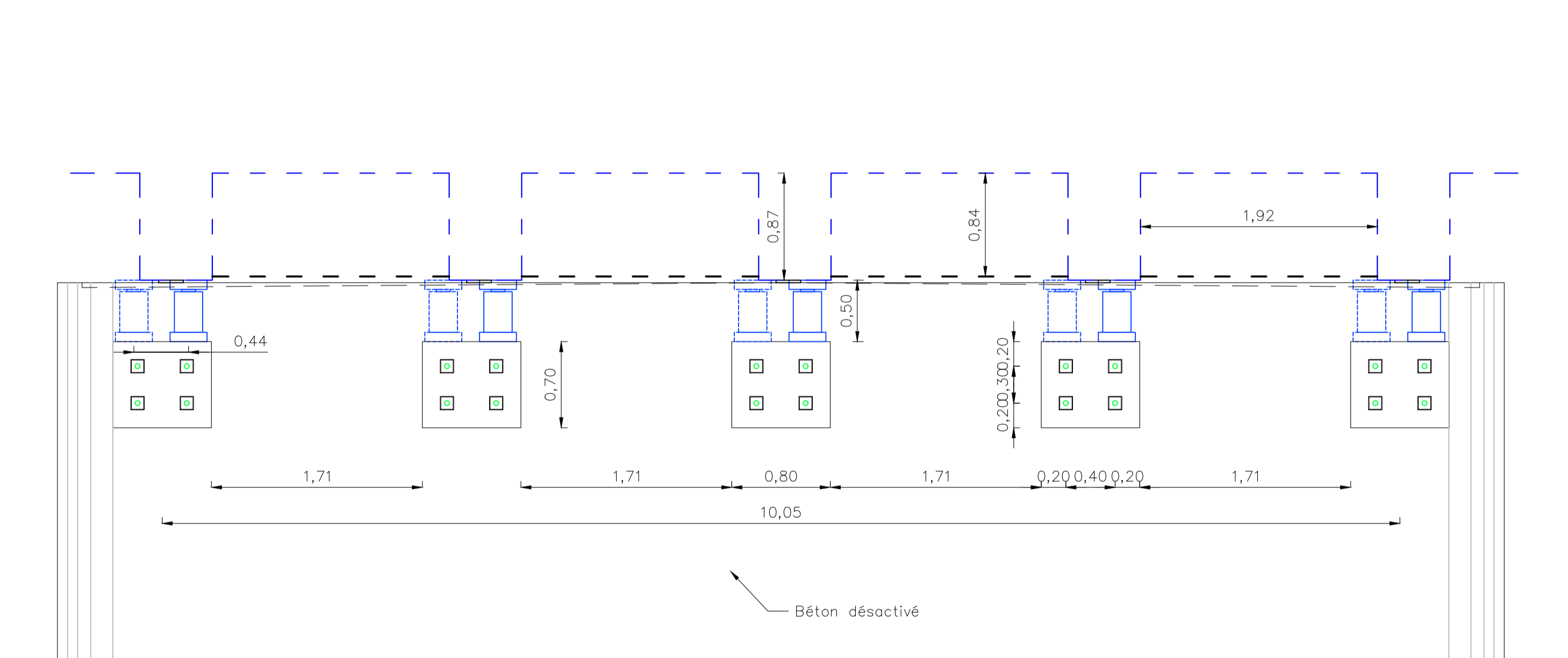

Vue en plan – Platine Soudé sur pile de rive

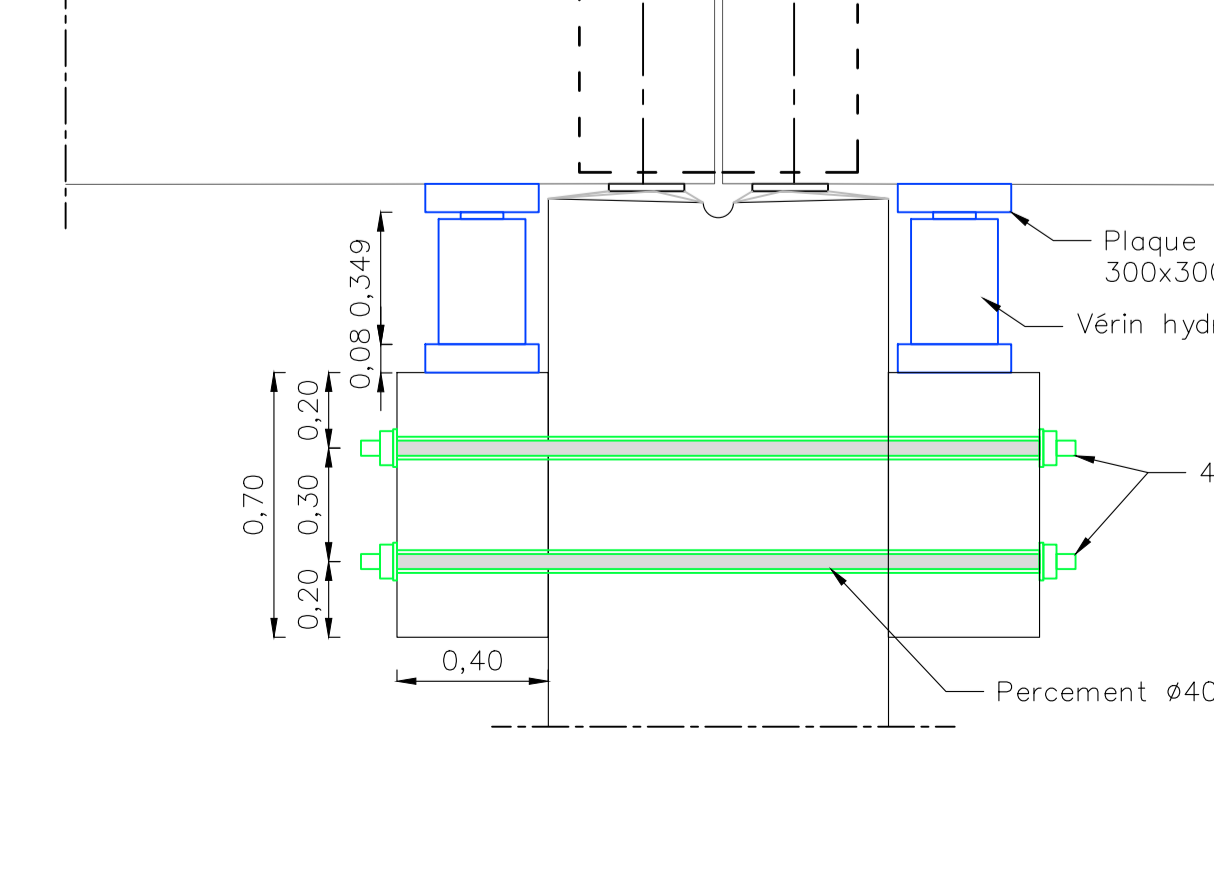
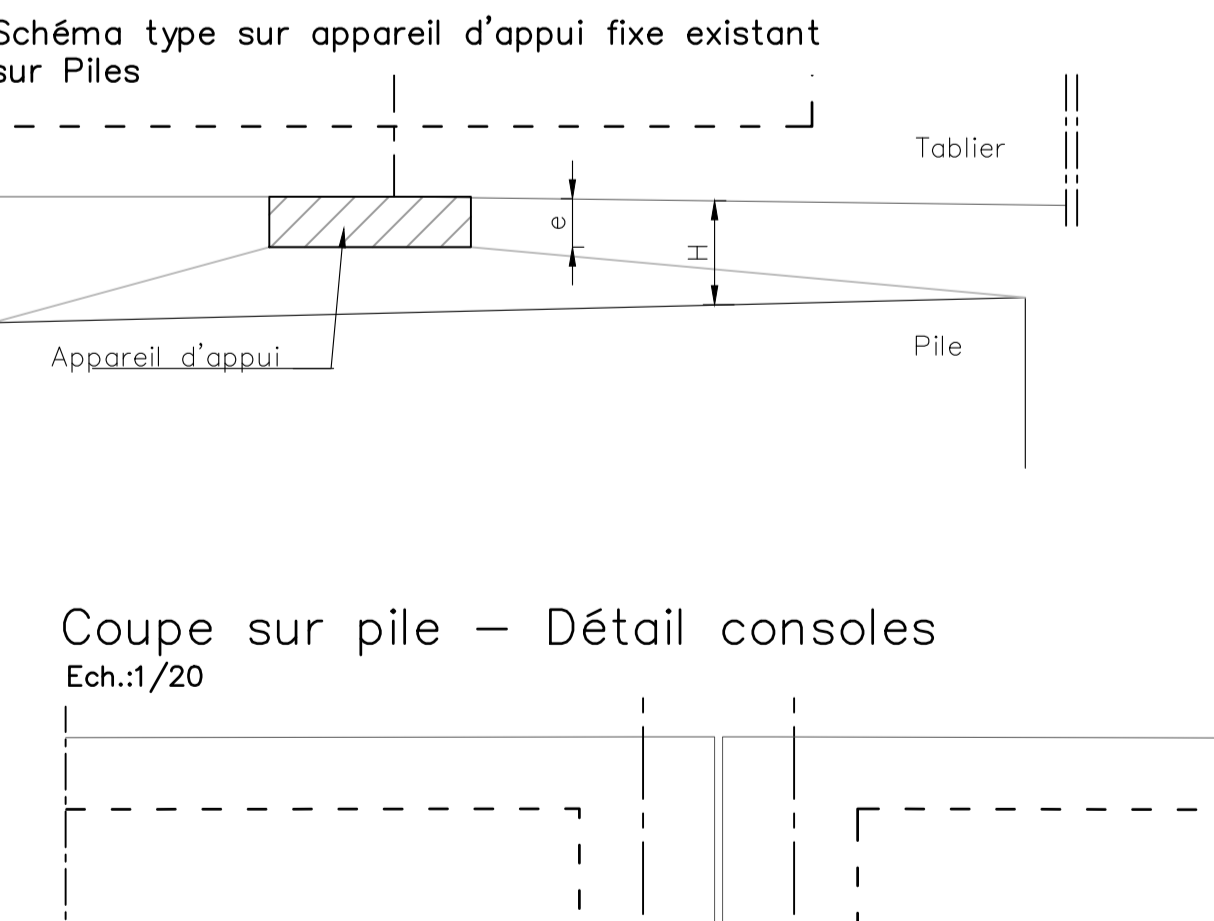
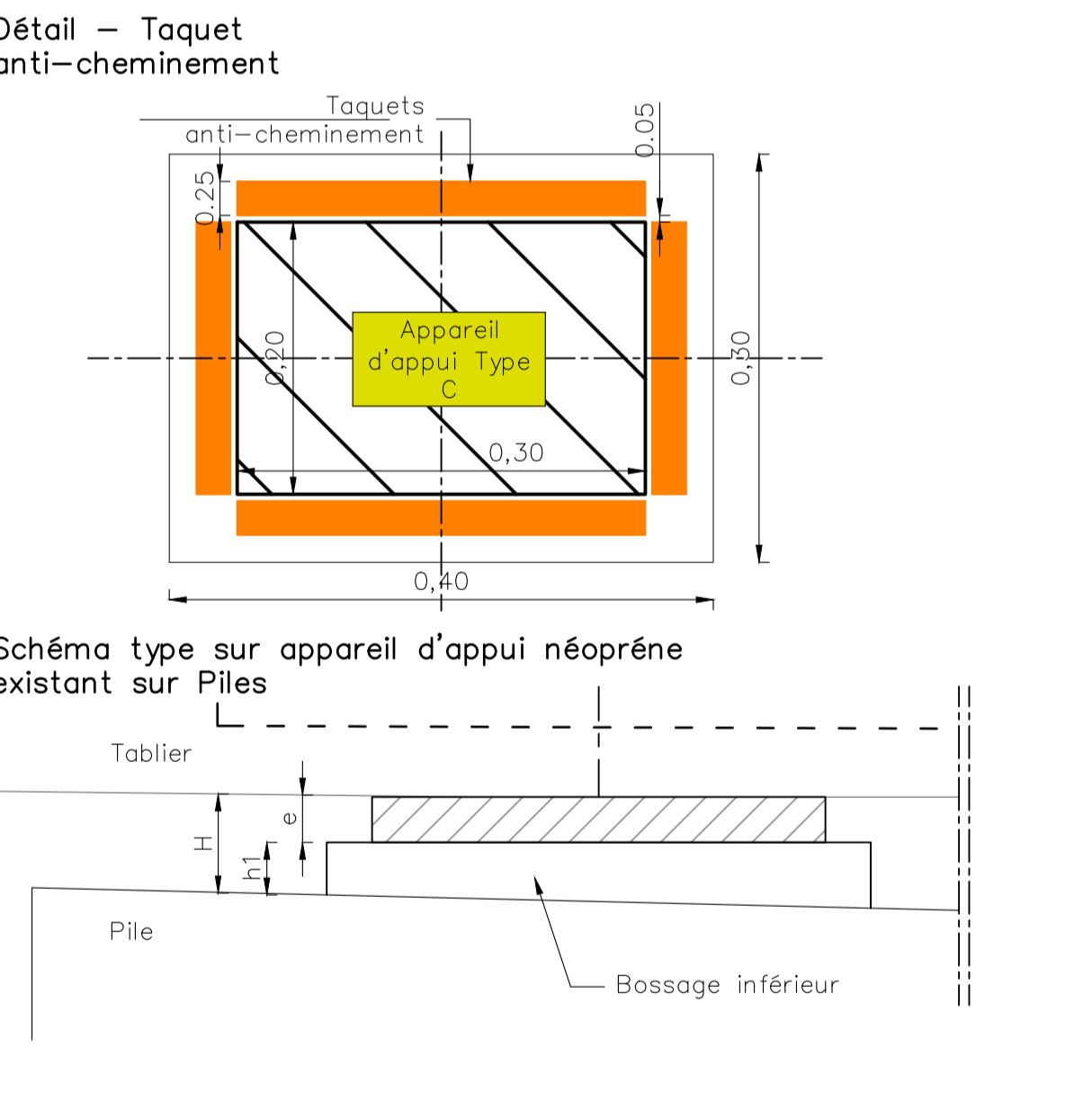

Hautsurs libres (H) et (e)

Appareils	e	h1	h2	H
Piles P2 et P4 RIVE	45	30	40	115
Piles P2 et P4 CENTRE	33	42	40	115
Pile P3	33	67	40	140

Dimensions des appareils

Appareils	Appareils en place (selon EN 1337-3)	Epaisseur associée	Appareils projetés (selon EN 1337-3)	Epaisseur associée
P2 et P4 RIVE	300 x 200 x 20 Appui néoprène	20	300 x 200 x 2 (8+3) : 4x2 TYPE C	33 +12
P3 P2 et P4 CENTRE	300 x 80 x 20 Poutille appui fixe	20	300 x 200 x 2 (8+3) : 4x2 TYPE B	33